

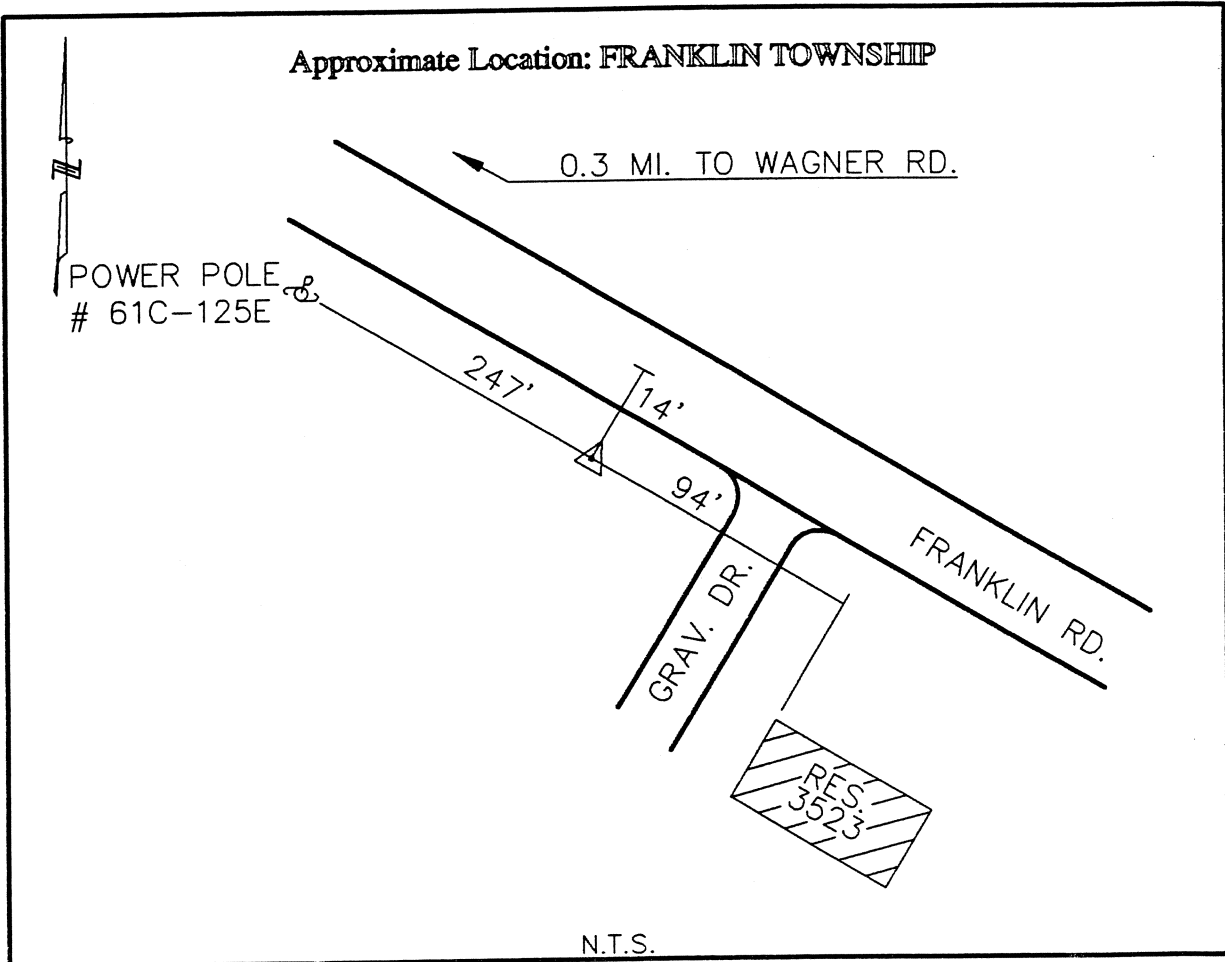

CLERMONT COUNTY ENGINEER  
CONTROL STATION DATA SHEET



Station Name: 296

NAD 1983 (First Order)	
State Plane Zone:	Ohio South 3402
Latitude (dms)	N 38 48 27.19692
Longitude (dms)	W 84 04 46.28200
Easting in meters	462810.631
Northing in meters	90849.823
Easting in US survey ft	1518404.544
Northing in US survey ft	298063.127
Scale	0.99998624
Convergence	-1 0 8.057022

NAVD 1988	
Elevation in meters	267.575
Elevation in feet	877.869
Geoid Ht in meters	-34.103
Elevations determined with GPS	

Azimuth: S 39° 16' 12" E to Station 296A.