

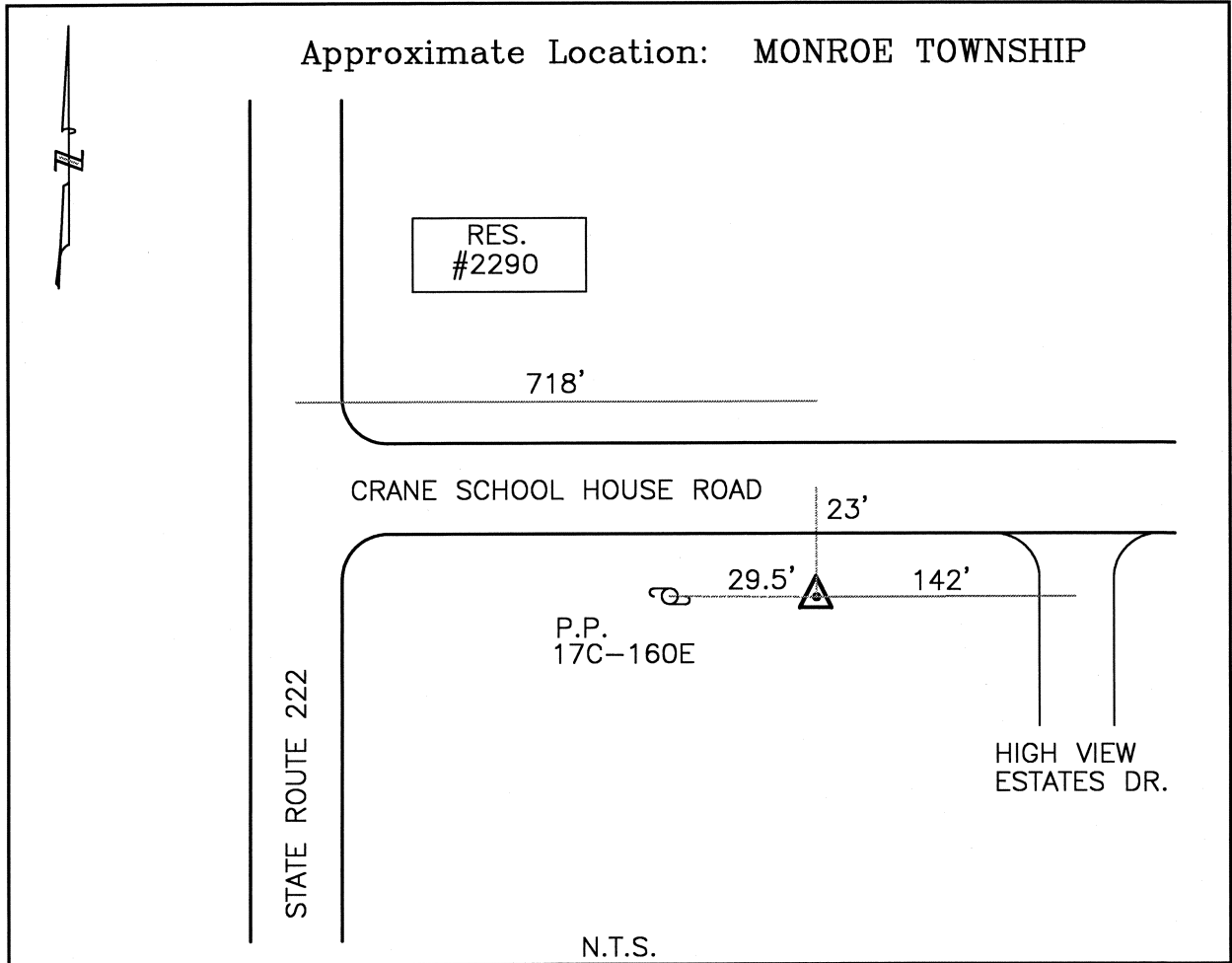

# CLERMONT COUNTY ENGINEER

## CONTROL STATION DATA SHEET



Station Name: 250

NAD 1983 (First Order)		NAVD 1988	
State Plane Zone:	Ohio South 3402	Elevation in meters	270.751
Latitude (dms)	N 38 58 4.89951	Elevation in feet	888.289
Longitude (dms)	W 84 09 40.79186	Geoid Ht in meters	-34.130
Easting in meters	456033.690	Elevations determined with GPS	
Northing in meters	108788.483		
Easting in US survey ft	1496170.530		
Northing in US survey ft	356916.881		
Scale	0.99996215		
Convergence	-1 3 14.929278		

Azimuth: S 85° 10' 15" E to Station 250A.