

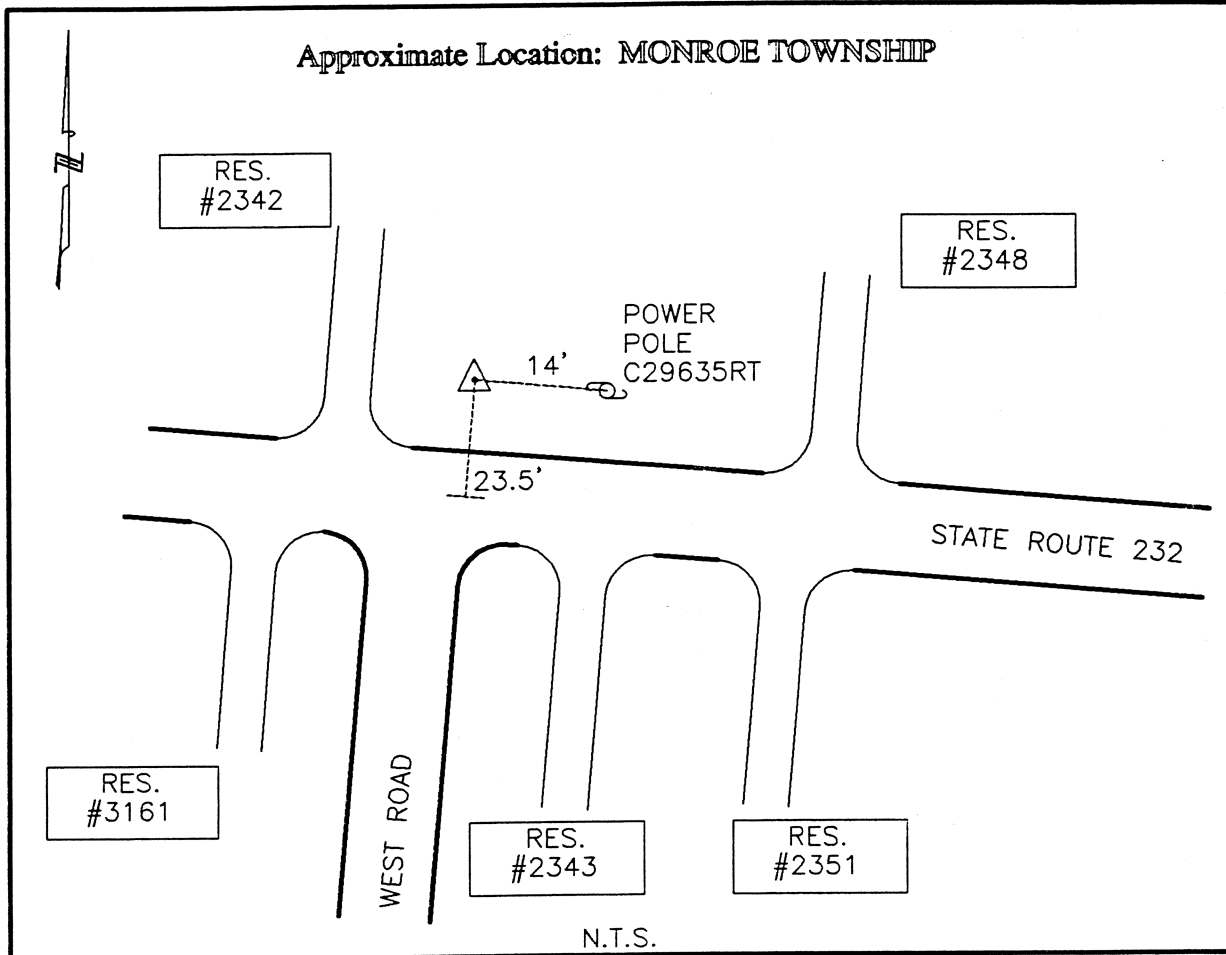

CLERMONT COUNTY ENGINEER
CONTROL STATION DATA SHEET

Approximate Location: MONROE TOWNSHIP



Station Name: 247

NAD 1983 (First Order)	Ohio South 3402
State Plane Zone:	N 38 55 55.36035
Latitude (dms)	W 84 09 30.61589
Longitude (dms)	456205.250
Easting in meters	104790.149
Northing in meters	1496733.390
Easting in US survey ft	343799.013
Northing in US survey ft	0.99996687
Scale	-1 3 8.472430
Convergence	

NAVD 1988	
Elevation in meters	273.399
Elevation in feet	896.977
Geoid Ht in meters	-34.141
Elevations determined with GPS	

Azimuth: S 25° 04' 28" W to Station 247A.