

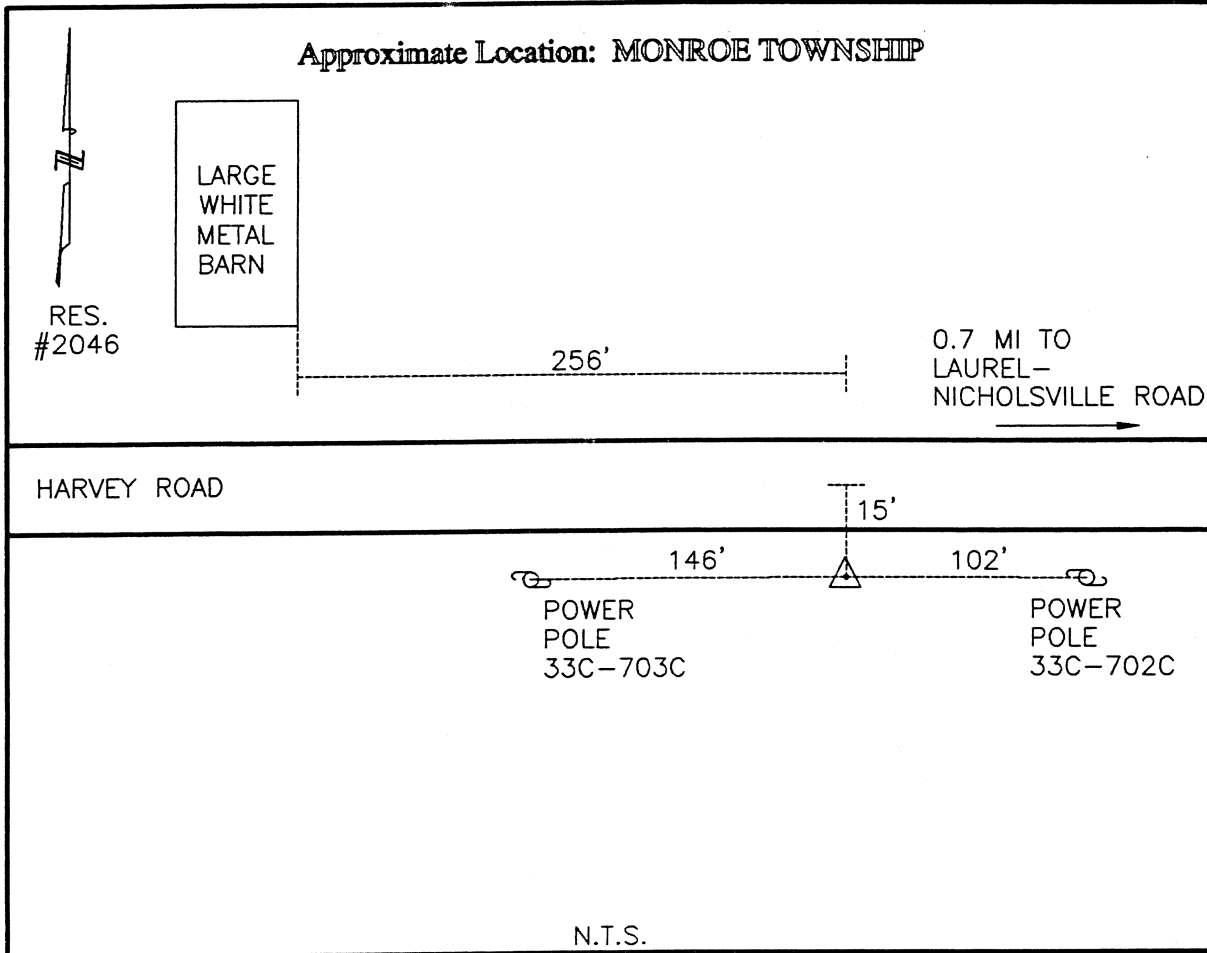

CLERMONT COUNTY ENGINEER
CONTROL STATION DATA SHEET



Station Name: 243

NAD 1983 (First Order)		NAVD 1988
State Plane Zone:	Ohio South 3402	Elevation in meters 274.219
Latitude (dms)	N 38 56 30.83447	Elevation in feet 899.667
Longitude (dms)	W 84 11 10.18146	Geoid Ht in meters -34.168
Easting in meters	453828.040	Elevations determined with GPS
Northing in meters	105928.257	
Easting in US survey ft	1488934.160	
Northing in US survey ft	347532.956	
Scale	0.99996554	
Convergence	-1 4 11.648725	

Azimuth: S 87° 24' 34" E to Station 243A.